

44 Rw, Single leaf, Acoustic Doorset (not fire rated)

DESCRIPTION

Pyropanel AS-44-PAC is a single leaf, 44 Rw acoustic doorset.

APPLICATIONS

Ideal for applications that require an acoustic rating of 44 Rw.

FEATURES

Acoustic Rating

- 44 Rw.

Smoke Resistance

- Doorset is fitted with smoke seals.

Door Configuration

- Single leaf.

Thickness

- 73mm-78mm nom. (depending on the facing thickness).

Door Weight

- Approx 53 kg/m²

Size

- Maximum Size - 2340 x 1020mm.

Hinges

- Minimum 4 steel hinges.

Frame

- Pyropanel Euroseal filled steel frame (1.6mm), with Pyropanel light weight M4 Mortar.

Finish

- MDF or Hardboard facing to both faces.

Seal combinations

Door Type	Perimeter	Bottom	Corner	Rw
AS-44-PAC	Pyropanel Euroseal + Lorient LAS7001si	Pyropanel PY-BSI	Pyropanel PY-CS1	44

OPTIONAL EXTRAS

- Decorative veneers.
- Pyropanel 13mm thick Vision panels - 300 x 200 or 600 x 100mm nom. (Rw 38). Note - The inclusion of a vision panel will cause a slight reduction in acoustic rating.

INSTALLATION

Door frame, door leaf & door seals should be sourced from a Pyropanel Authorised Licensee as a complete set. Door frame must be tightly sealed against wall structure using Pyropanel Pyropanel Euroseal acoustic sealant. Steel frames require backfilling with Pyropanel light-weight M4 Mortar to achieve the acoustic rating.

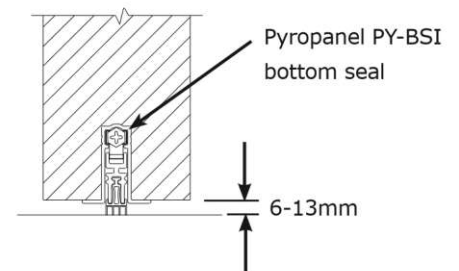
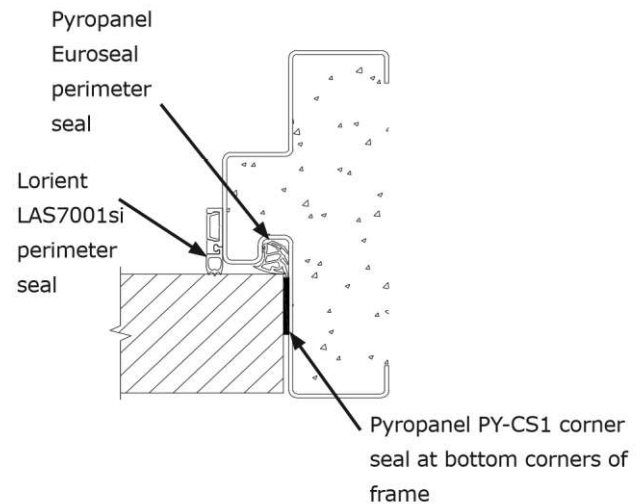

HOW TO SPECIFY

"Doorset to be a Pyropanel AS-44-PAC acoustic door, installed into a Pyropanel Euroseal filled steel door frame".

ASSA ABLOY Australia Pty Ltd

235 Huntingdale Road Oakleigh Vic 3166

Ph: (03) 9837 8500

Email: sales@pyropanel.com.au

Web: www.pyropanel.com.au

ASSA ABLOY Australia P/L has a policy of continuous improvement and reserves the right to change methods and specifications without notice. Note: The Tech Sheet is an uncontrolled document. If printed please refer to the Tech-Sheet on the website to check if this document is valid.

Distributed by:

