

# ASSA ABLOY

## 2 hr fire rated, (37 - 40 Rw), Single leaf, Acoustic/Smoke/Fire doorset

### DESCRIPTION

Pyropanel AS-FRB-B is a 2 hour fire rated, 55mm nominal single leaf acoustic doorset (up to 40 Rw).

### APPLICATIONS

Ideal for applications that requires up to 2 hours of fire resistance and an acoustic rating of up to 40 Rw, such as warehouses, factories and other commercial applications.

### FEATURES

#### Acoustic Rating

- Up to 40 Rw (see seal combinations in table below)

#### Fire Resistance

- /120/30

#### Smoke Resistance

- Meets the NCC requirement for a smoke door.

#### Door Configuration

- Single leaf

#### Thickness

- 55mm (nominal)

#### Door Weight

- Approx 53 kg/m<sup>2</sup>

#### Size

- Maximum Size - 2400 x 1020mm (For Masonry, Concrete, Hebel and Plasterboard Walls)
- For other wall types, please contact your preferred Pyropanel distributor.

#### Frame

- Pyropanel Euroseal steel frame (filled).

#### Finish

- Ply or steel to both faces.

#### Seal combinations

Door Type	Perimeter	Bottom	Rw
AS-FRB-B1	Euroseal	Lorient LAS8001 + LAS8006 or Lorient LAS8001 + LAS8009	40
AS-FRB-B2	Euroseal	LAS8006 or LAS8009	39
AS-FRB-B3	Euroseal	Lorient LAS8001	37

### OPTIONAL EXTRAS

- Pre-hung in steel frame.
- Stainless steel faces.
- Pyropanel Pyrodur 13mm thick vision panels - 300 x 200 or 600 x 100mm nom. (Rw 38)
- Kick Panels of 1mm Stainless Steel to selected height.

### INSTALLATION

Door frame must be tightly sealed against wall structure using Pyropanel Pyroseal sealant. Steel frames require filling with fire rated plasterboard, Pyropanel light weight M4 Mortar, concrete or mortar to achieve the desired acoustic and fire rating.

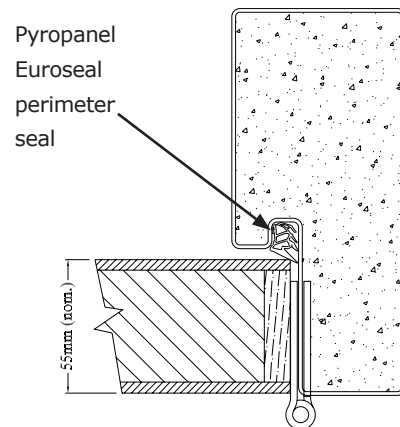

#### B1

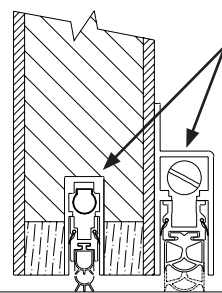

#### B3

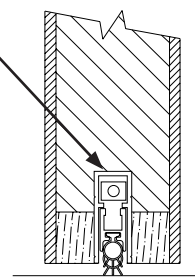

Bottom seal  
(Example only, see table for other seal options)

### HOW TO SPECIFY

"Door to be a Pyropanel AS-FRB-B1\* acoustic door with -/120/30 FRL\*, installed in a Pyropanel Euroseal filled steel door frame\*".

\* denotes example - delete, change or specify as required

### ASSA ABLOY Australia Pty Ltd

235 Huntingdale Rd, Oakleigh, Vic 3166

Ph: **(03) 9837 8500**

Email: [sales@pyropanel.com.au](mailto:sales@pyropanel.com.au)

Web: [www.pyropanel.com.au](http://www.pyropanel.com.au)

ASSA ABLOY Australia P/L has a policy of continuous improvement and reserves the right to change methods and specifications without notice. Note: *The Tech Sheet is an uncontrolled document. If printed please refer to the Tech-Sheet on the website to check if this document is valid.*

### Distributed by: