

1 hr fire rated, 30 Rw, Single leaf, Acoustic/Smoke/Fire doorset

DESCRIPTION

Pyropanel AS-30-PAN-E is a 30 Rw, 1 hour fire rated 48mm nominal single leaf acoustic doorset that utilises a Pyropanel Euroseal concealed perimeter seal and an approved bottom seal.

APPLICATIONS

Ideal for unit entry applications or anywhere that requires 60 minutes of fire resistance and an acoustic rating of 30 Rw.

FEATURES

Acoustic Rating

- 30 Rw

Fire Resistance

- FRL -/60/30

Smoke Resistance

- Meets the NCC requirement for a smoke door.

Door Configuration

- Single leaf, hung in a steel or timber frame.

Thickness

- 48mm (nominal)

Door Weight

- Approx 21 kg/m²

Size

- Maximum Size - 2420 x 1020 or 2200 x 1120 (-/60/30)

Hinges

- Minimum 3 steel hinges.

Frame

- Pyropanel Euroseal KDHW timber or fully filled steel frame.

Finish

- MDF as standard.

Perimeter Seals

- Pyropanel Euroseal® concealed smoke/acoustic seal.

Bottom Seals

- See seal combinations listed on page 2.

OPTIONAL EXTRAS

- Pre-hung in steel or timber frame
- Ply, Veneer, Steel or Laminate facings
- Vision panels - 300 x 200 or 600 x 100mm nom.
- Kick Panels of 1mm Stainless Steel to selected height.

INSTALLATION

Door frame must be tightly sealed against wall structure using Pyropanel Pyroseal fire and acoustic sealant. Steel door frames require filling with fire rated plasterboard, Pyropanel light weight M4 Mortar, concrete or mortar to achieve the desired acoustic rating.

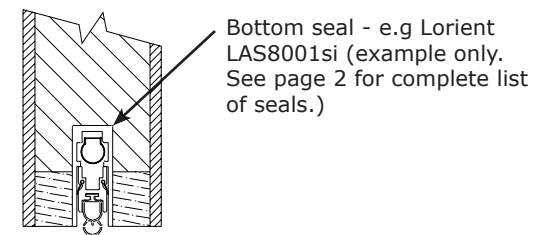
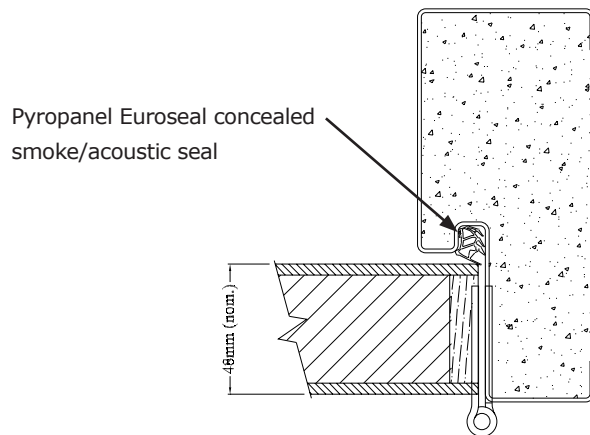

HOW TO SPECIFY

"Door to be a Pyropanel AS-30-PAN-E acoustic door with -/60/30* FRL, installed into a Pyropanel Fire rated timber / filled steel* door frame, with Pyropanel Euroseal and Lorient LAS8001si* seals".

* denotes example - delete, change or specify as required

ASSA ABLOY Australia Pty Ltd

235 Huntingdale Rd, Oakleigh, Vic 3166

Ph: **(03) 9837 8500**

Email: **sales@pyropanel.com.au**

Web: **www.pyropanel.com.au**

ASSA ABLOY Australia P/L has a policy of continuous improvement and reserves the right to change methods and specifications without notice. Note: *The Tech Sheet is an uncontrolled document. If printed please refer to the Tech-Sheet on the website to check if this document is valid.*

Distributed by:

1 hr fire rated, 30 Rw, Single leaf, Acoustic/Smoke/Fire doorset

SEAL COMBINATIONS

Door Type	Perimeter Seals	Bottom Seals
AS-30-PAN-E	Pyropanel Euroseal	Lorient LAS8001si
		Lorient LAS8002si
		Lorient LAS8003si
		Lorient LAS8005si
		Lorient LAS8006si
		Lorient LAS8007si
		Lorient LAS8008si
		Lorient LAS8009si

ASSA ABLOY Australia Pty Ltd

235 Huntingdale Rd, Oakleigh, Vic 3166

Ph: **(03) 9837 8500**Email: **sales@pyropanel.com.au**Web: **www.pyropanel.com.au****Distributed by:**