

# FIRE RATED ACCESS PANEL

## Lift motor room hatch / floor access panel

### DESCRIPTION

Specifically designed for lift motor room and plant room hatches, these units are manufactured to size and incorporate a steel checker plate cover, and a special four sided pressed metal frame which is suitable for casting into concrete floors.

### APPLICATIONS

Lift shafts, motor rooms, plant rooms, or any application that requires access through a fire rated concrete floor.

### FEATURES

- Anodised aluminium channel to four edges
- Ply or steel faced
- 48mm thick
- Screw fixed
- Recessed finger grips provided
- Finger holes provided in checker plate steel cover
- NOTE: Panels are non-structural and must not have any load directly applied - Steel checker plate is mandatory where there is any risk of load (including people) being applied
- Integrated hot smoke / fire seals included
- Medium temperature smoke seals available
- Singles or pairs with removeable mullion
- Deletion of Steel checker plate will reduce insulation value to 60 minutes.

### MODELS

Model	FRL	Thickness	Max Size Single Panel	Max Size Per Panel For Pairs
PFAP-240/120	-/240/120	48	1750 x 550 (Opening = 1690 x 490)	N/A
PFAP-120/120	-/120/120	48	1325 x 885 (Opening = 1265 x 825)	1325 x 885 (Opening = 1265 x 825)

### HOW TO SPECIFY

"Eg. Access panel to be a Pyropanel fire rated floor access panel PFAP-240/120\*, FRL -/240/120\*, Ply face\*, screw fixings.

\* denotes example - delete, change or specify as required

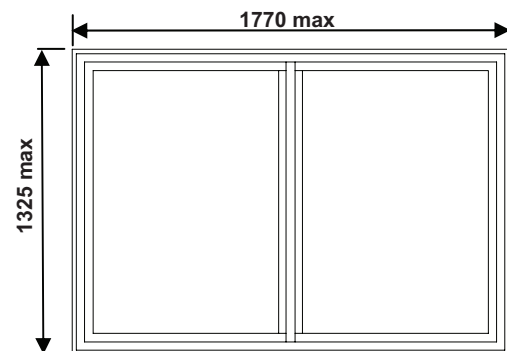
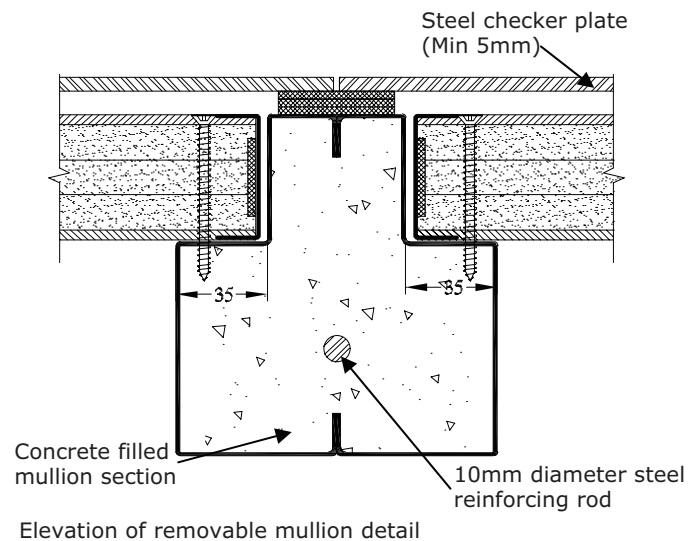
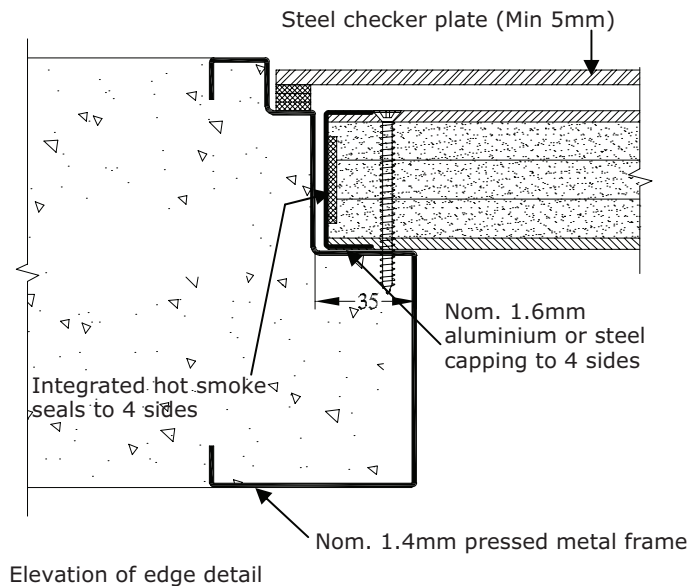

**Pyropanel Developments Pty Ltd**  
 235 Huntingdale Road, Oakleigh, Vic 3166  
 Ph: (03) 9837 8500 Fax: (03) 9837 8550  
 Email: [sales@pyropanel.com.au](mailto:sales@pyropanel.com.au)  
 Web: [www.pyropanel.com.au](http://www.pyropanel.com.au)

**Distributed by:**  
**Nexdor Systems**  
 Ph: (03) 5450 3457  
 Email: [estimating@nexdorsystems.com.au](mailto:estimating@nexdorsystems.com.au)  
 Web: [www.nexdorsystems.com.au](http://www.nexdorsystems.com.au)

