

Speedpanel walls (51, 64 & 78mm)

DESCRIPTION

Building-in details showing the approved fixing methods for Pyropanel 48mm nominal doors in Speedpanel walls for up to 2 hours of fire rating (51mm = 1 hr, 64mm = 1.5 hrs, 78mm = 2 hrs).

Slide-in & Built-in details with Speedpanels and optional plasterboard linings

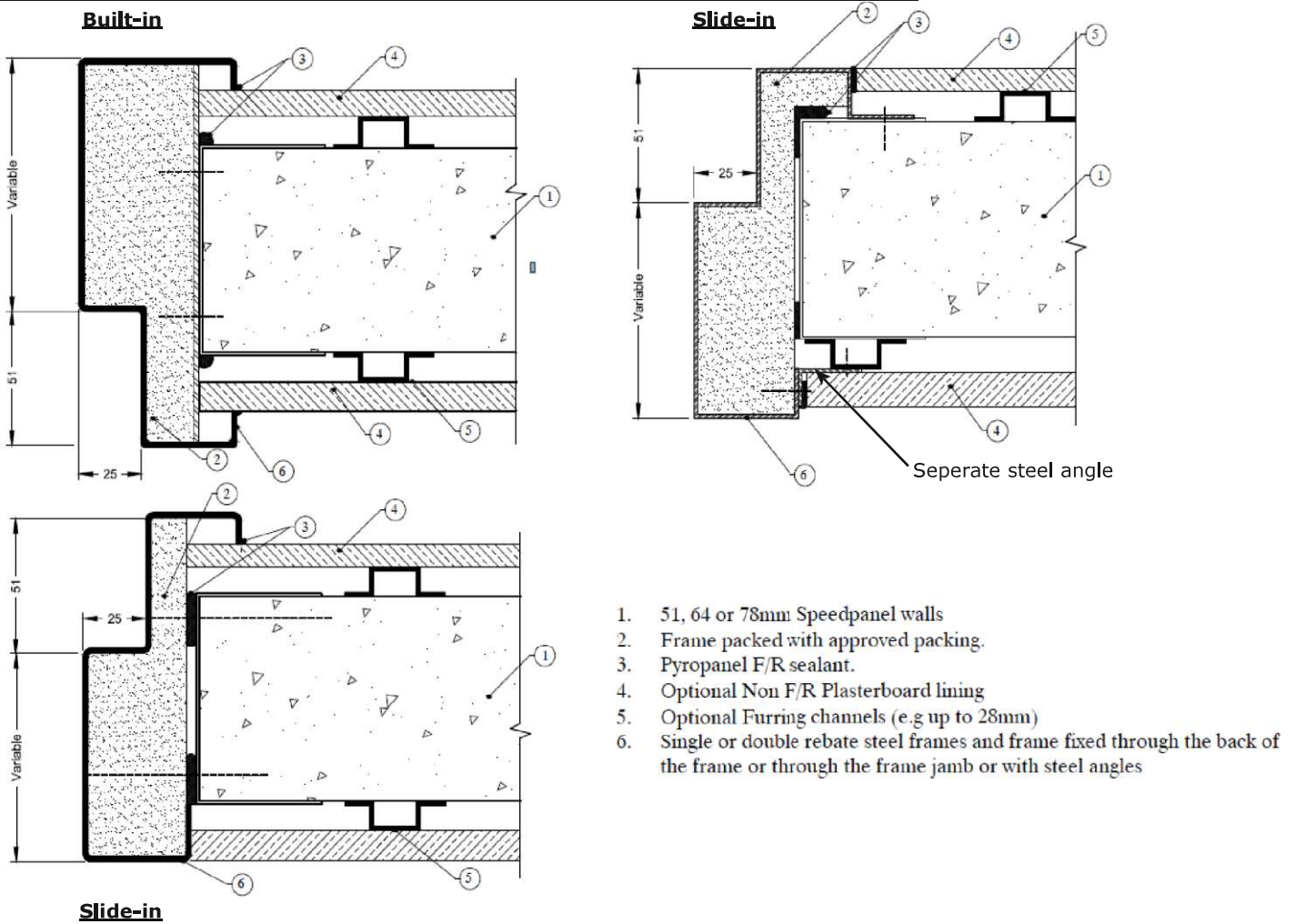

Note: Approved frame packing materials: Fire rated plasterboard, Pyropanel M4 lightweight mortar or mortar. Frames screw fixed at nominal 400mm centres.

Speedpanel walls (51, 64 & 78mm)

BUILDING DETAILS CONTINUED...

Building-in details showing the approved fixing methods for Pyropanel 48mm nominal doors in Speedpanel walls for up to 2 hours of fire rating (51mm = 1 hr, 64mm = 1.5 hrs, 78mm = 2 hrs)

Slide-in & Built-in details with Speedpanel + plasterboard walls (one side)

ASSA ABLOY Australia Pty Ltd
235 Huntingdale Rd, Oakleigh, Vi3166
Ph: (03) 9837 8500
Email: sales@pyropanel.com.au
Web: www.pyropanel.com.au

Distributed by:



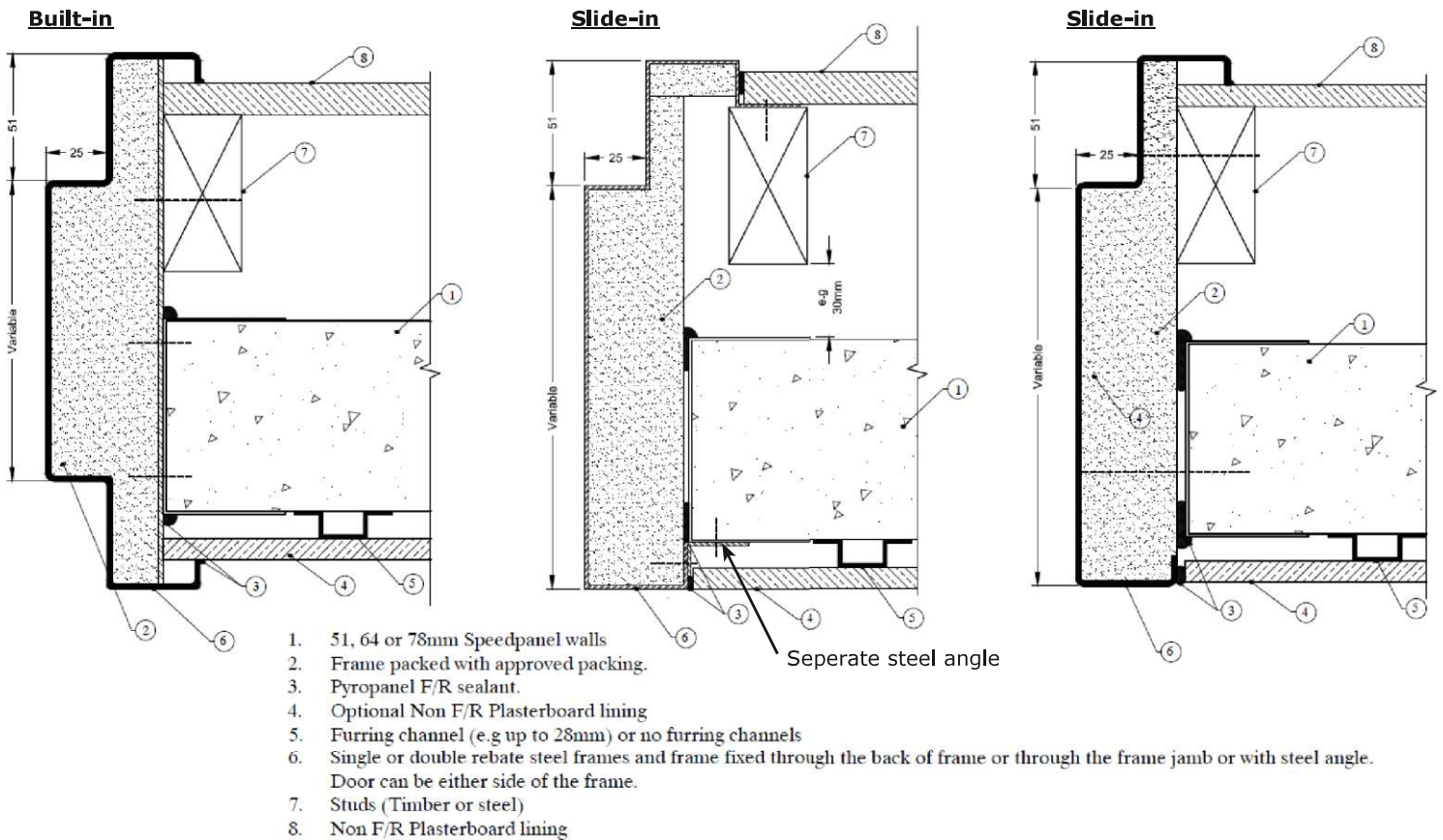

Note: Approved frame packing materials: Fire rated plasterboard, Pyropanel M4 lightweight mortar or mortar. Frames screw fixed at nominal 400mm centres.

Speedpanel walls (51, 64 & 78mm)

BUILDING DETAILS CONTINUED...

Building-in details showing the approved fixing methods for Pyropanel 48mm nominal doors in Speedpanel walls for up to 2 hours of fire rating (51mm = 1 hr, 64mm = 1.5 hrs, 78mm = 2 hrs)

Slide-in & Built-in details with Speedpanel + plasterboard walls (either side)

ASSA ABLOY Australia Pty Ltd
235 Huntingdale Rd, Oakleigh, Vi3166
Ph: (03) 9837 8500
Email: sales@pyropanel.com.au
Web: www.pyropanel.com.au

Distributed by:



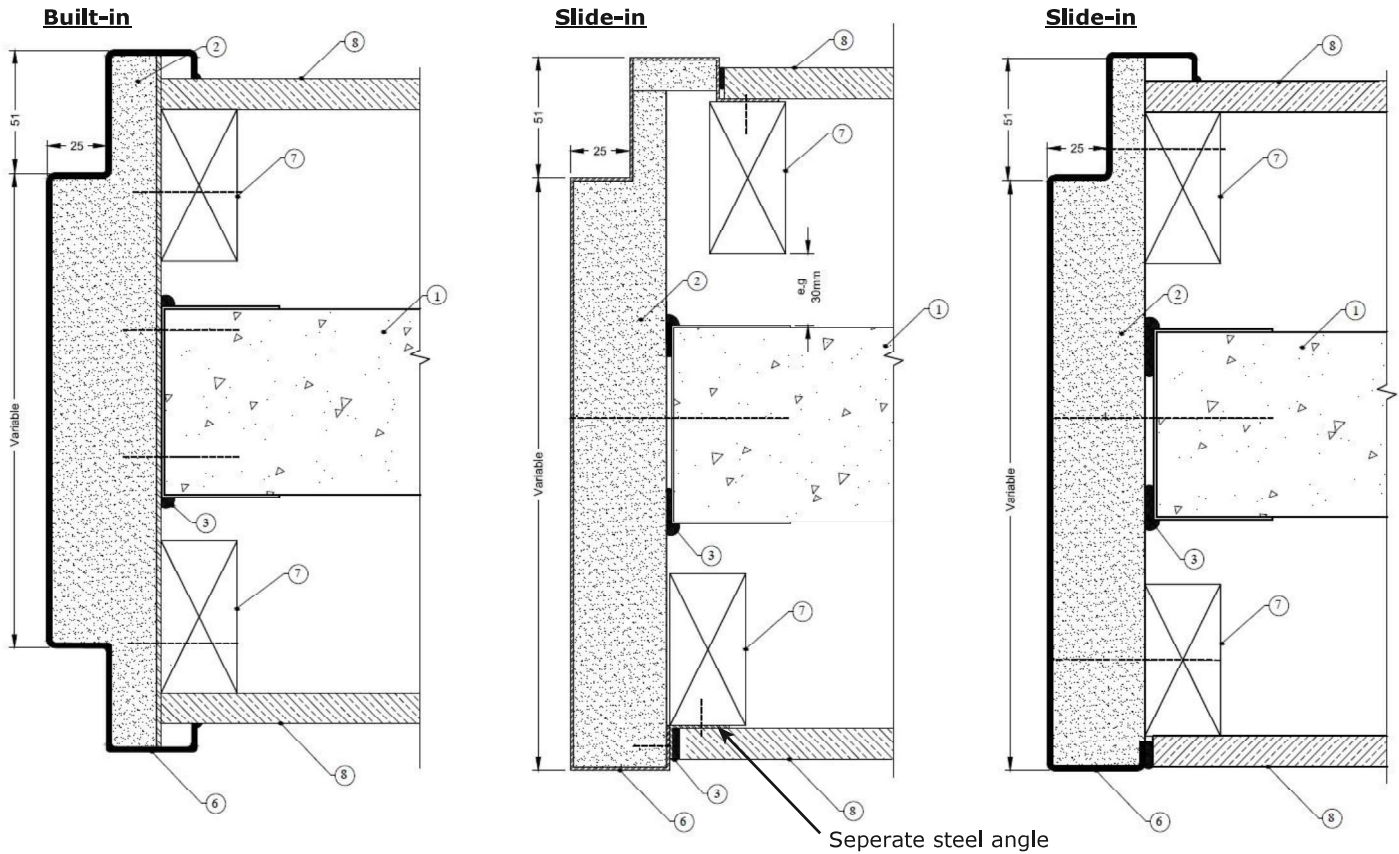

Note: Approved frame packing materials: Fire rated plasterboard, Pyropanel M4 lightweight mortar or mortar. Frames screw fixed at nominal 400mm centres.

Fire Rated "Slide-in" Frames for Speedpanel walls

Frame "Slide In" Profiles for Pyropanel Doors in Speedpanel Walls:

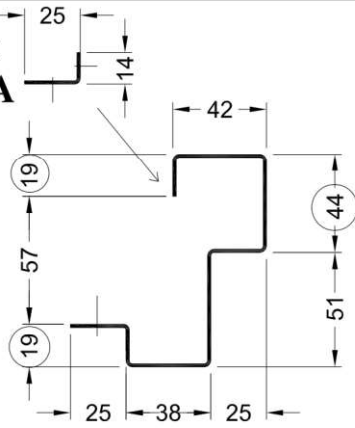
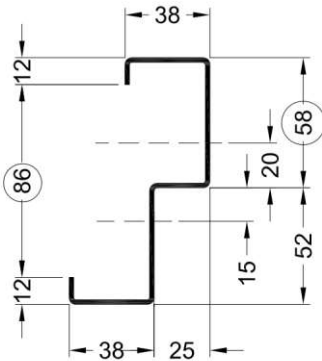
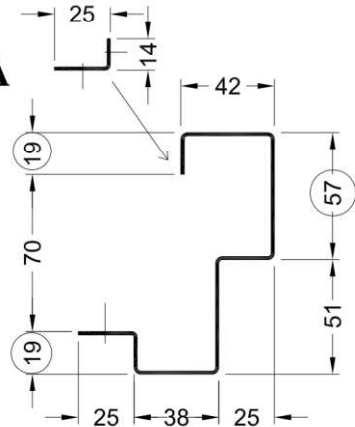
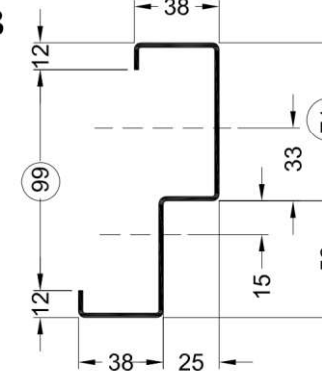
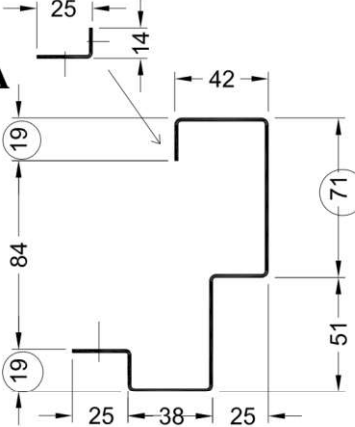
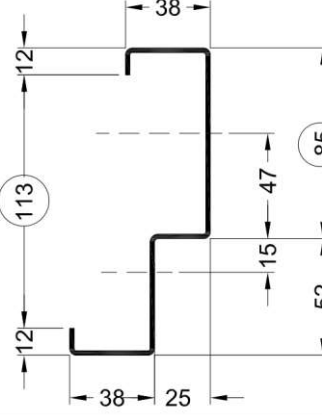
WALL TH. FRL	NB: All circled dimensions are for 13mm p'brd each side of wall. Will vary for different wall coverings.	
	Type A (edge fixed) Steel Thickness 1.2mm-1.4mm	Type B (face fixed) Steel Thickness 1.4mm-1.6mm
Wall: 51mm FRL: -/60/30	Profile: FSP51A 	Profile: FSP51B 
Wall: 64mm FRL: -/90/30	Profile: FSP64A 	Profile: FSP64B 
Wall: 78mm FRL: -/120/30	Profile: FSP78A 	Profile: FSP78B 

Fire Rated "Slide-in" Frames for Speedpanel walls

Frame "Built In" Profiles for Pyropanel Doors in Speedpanel Walls:

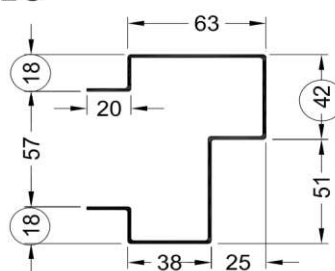
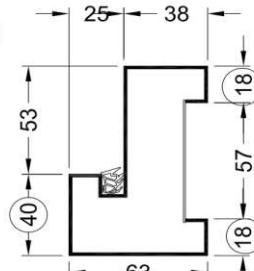
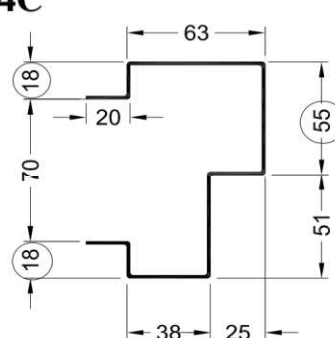
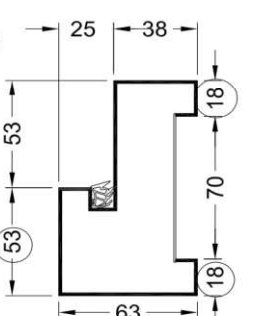
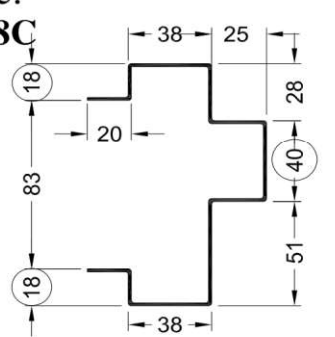
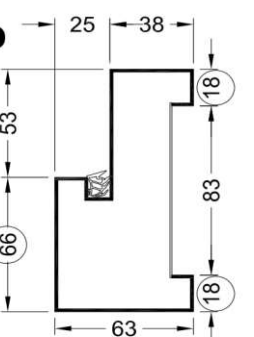
WALL TH. FRL	NB: All circled dimensions are for 13mm p'brd each side of wall. Will vary for different wall coverings.	
	Type C fixing Steel Thickness: 1.4mm	Type D fixing Steel Thickness: 1.4mm
Wall: 51mm FRL: -/60/30	Profile: FSP51C 	Profile: FSP51D 
Wall: 64mm FRL: -/90/30	Profile: FSP64C 	Profile: FSP64D 
Wall: 78mm FRL: -/120/30	Profile: FSP78C 	Profile: FSP78D 

HOW TO SPECIFY

"Door frame to be a Pyropanel FSP78B* Prime painted pressed metal door frame. Builder to confirm door frame applicability".

*Denotes example - change to suit requirements